

### E01 Kurbelgehäuse kpl. und Variomatikdeckel

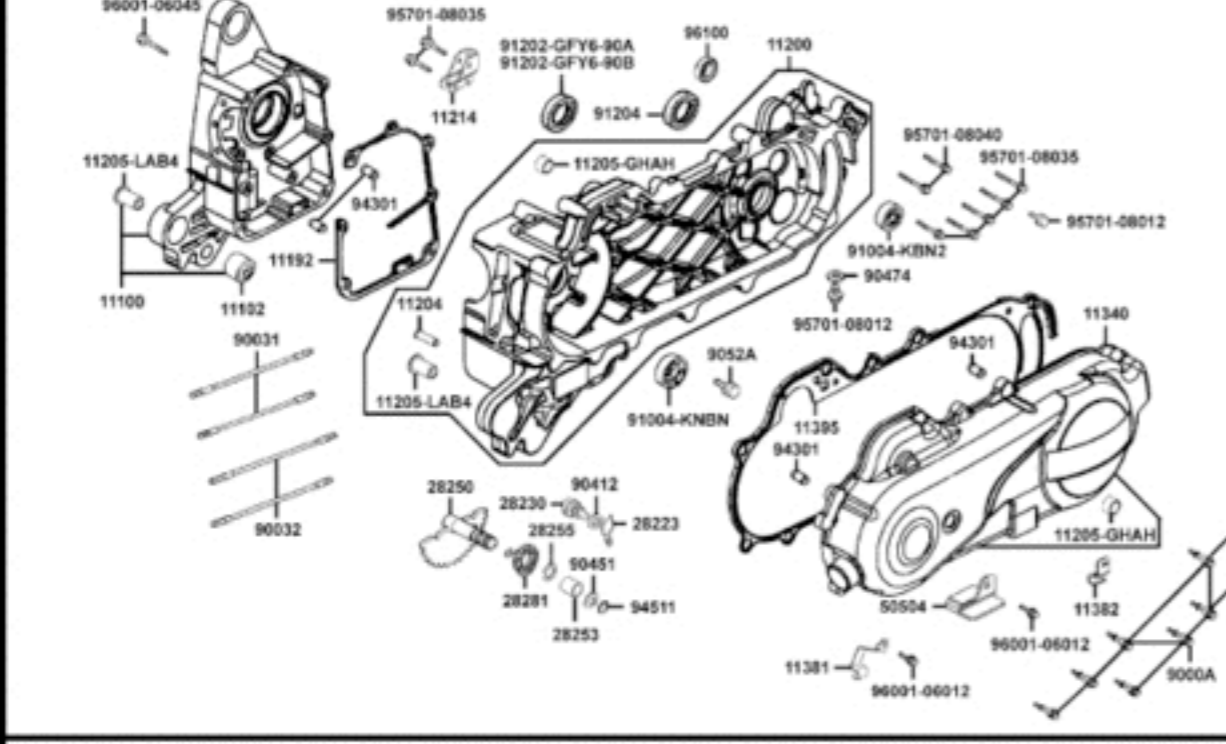

### E02 Zylinderkopf und Ventiltrieb

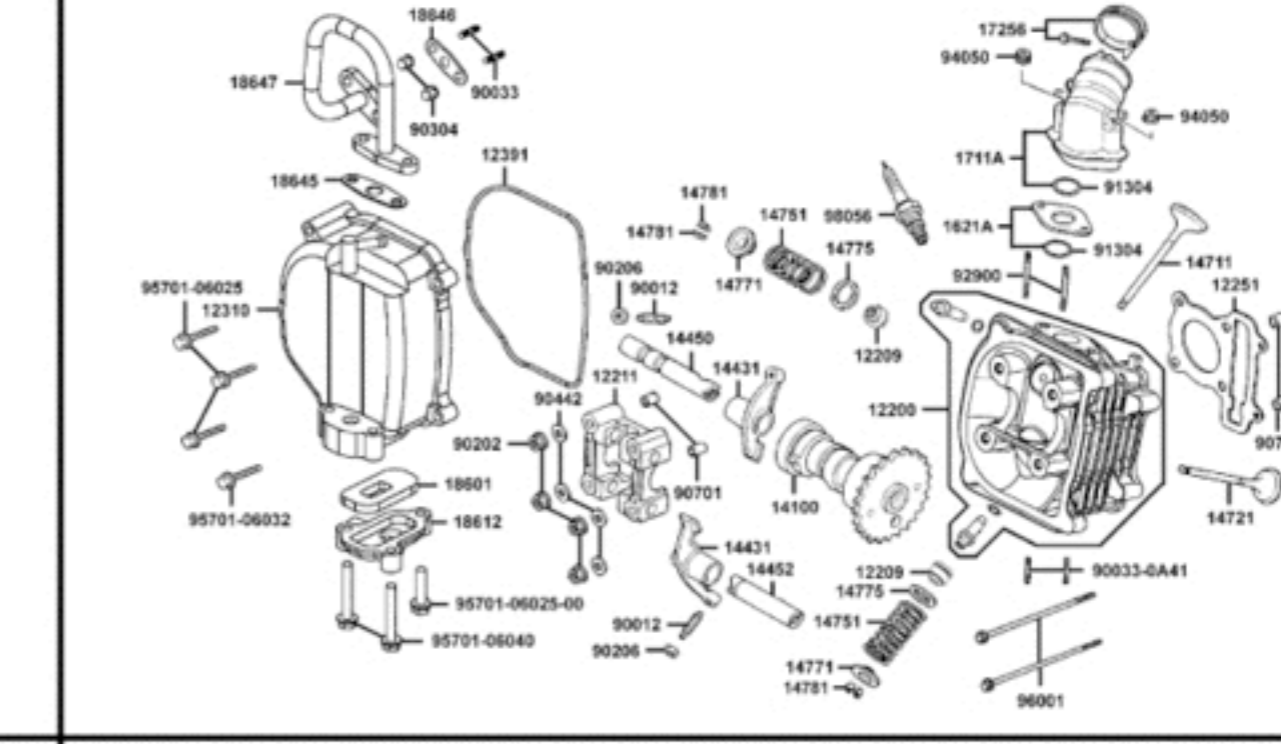

### E03 Zylinder, Kolben und Pleuellwelle

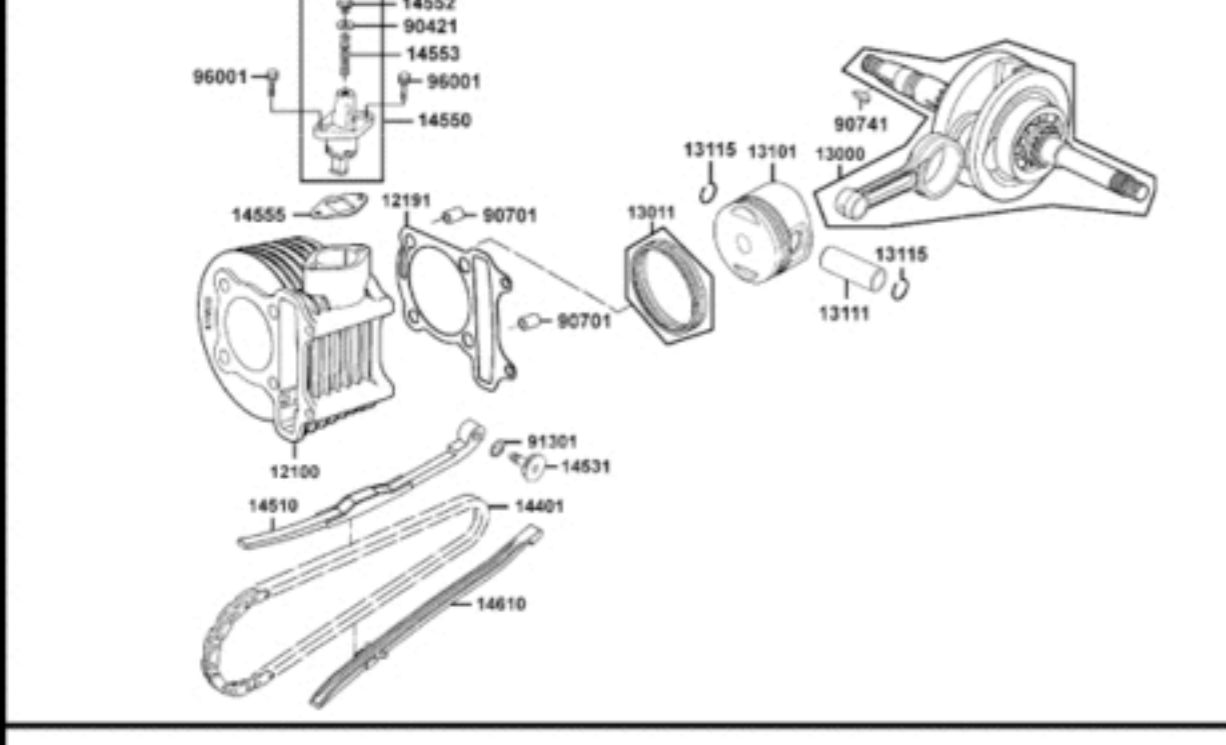

### E04 Kurbelgehäusedeckel rechts

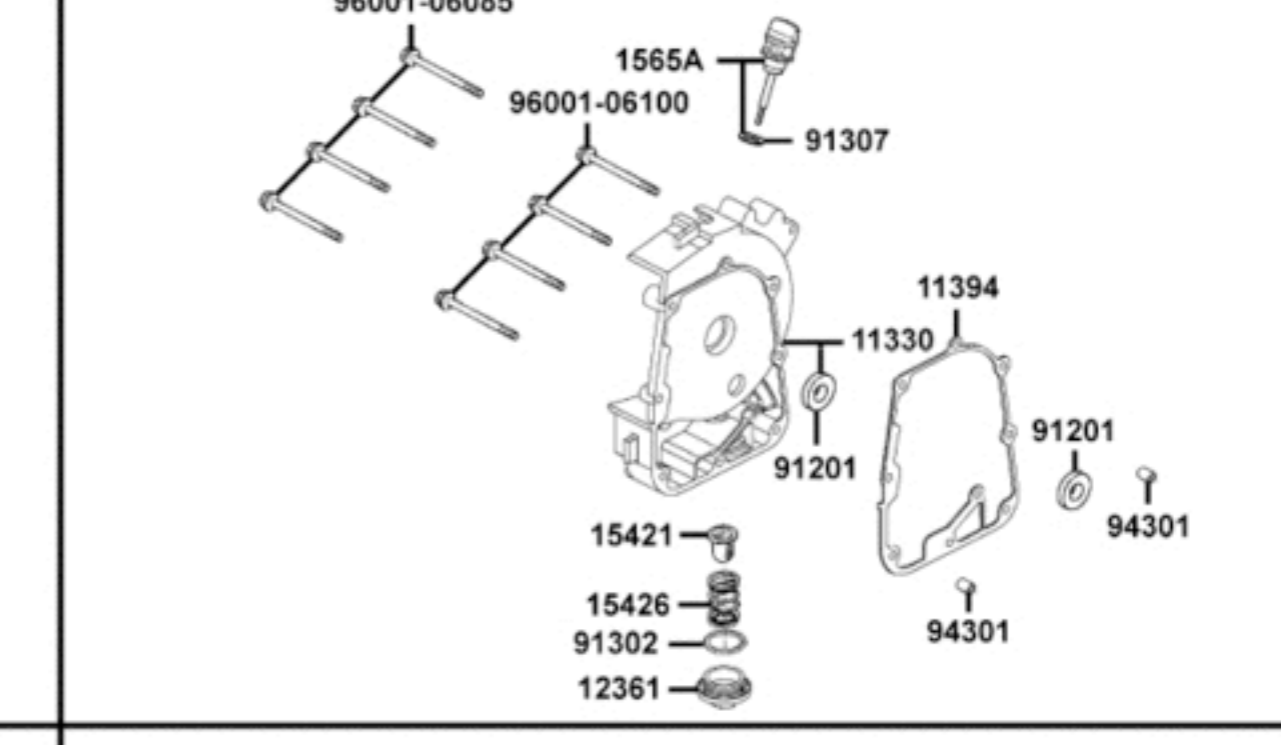

### E05 Fliehkraftkupplung und Variomatik

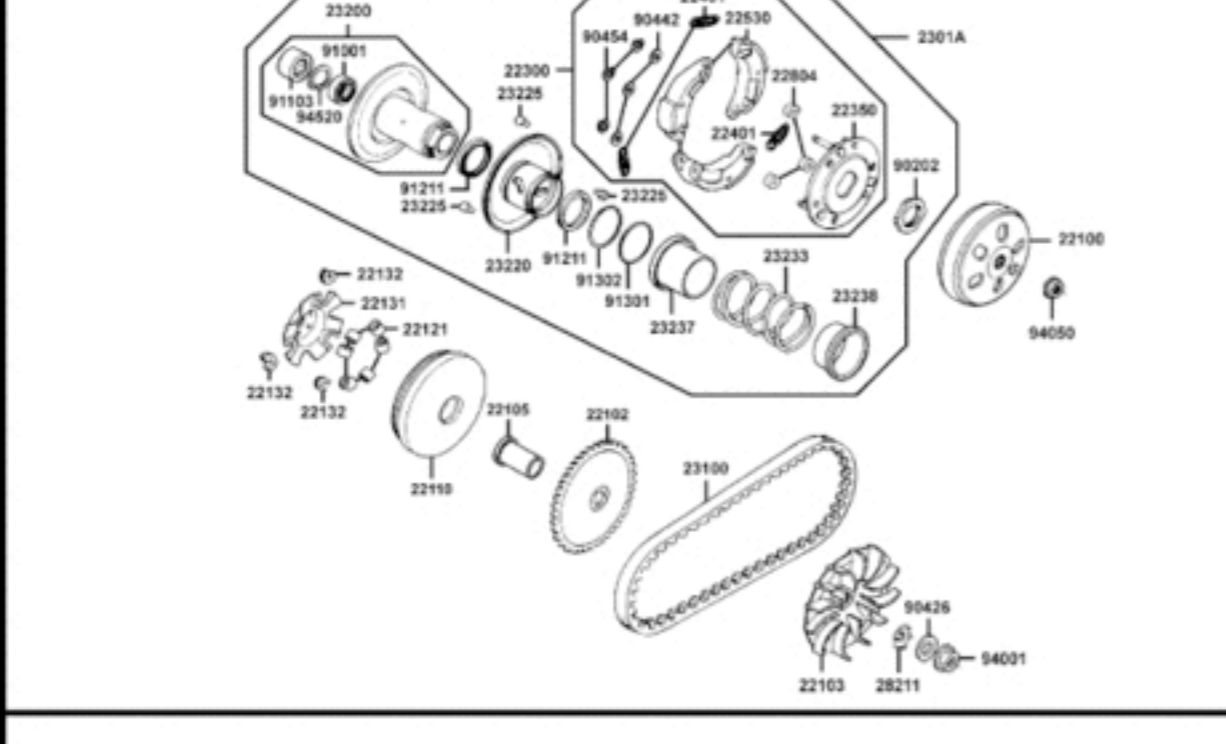

### E06 Elektrischer Anlasser und Ölpumpe

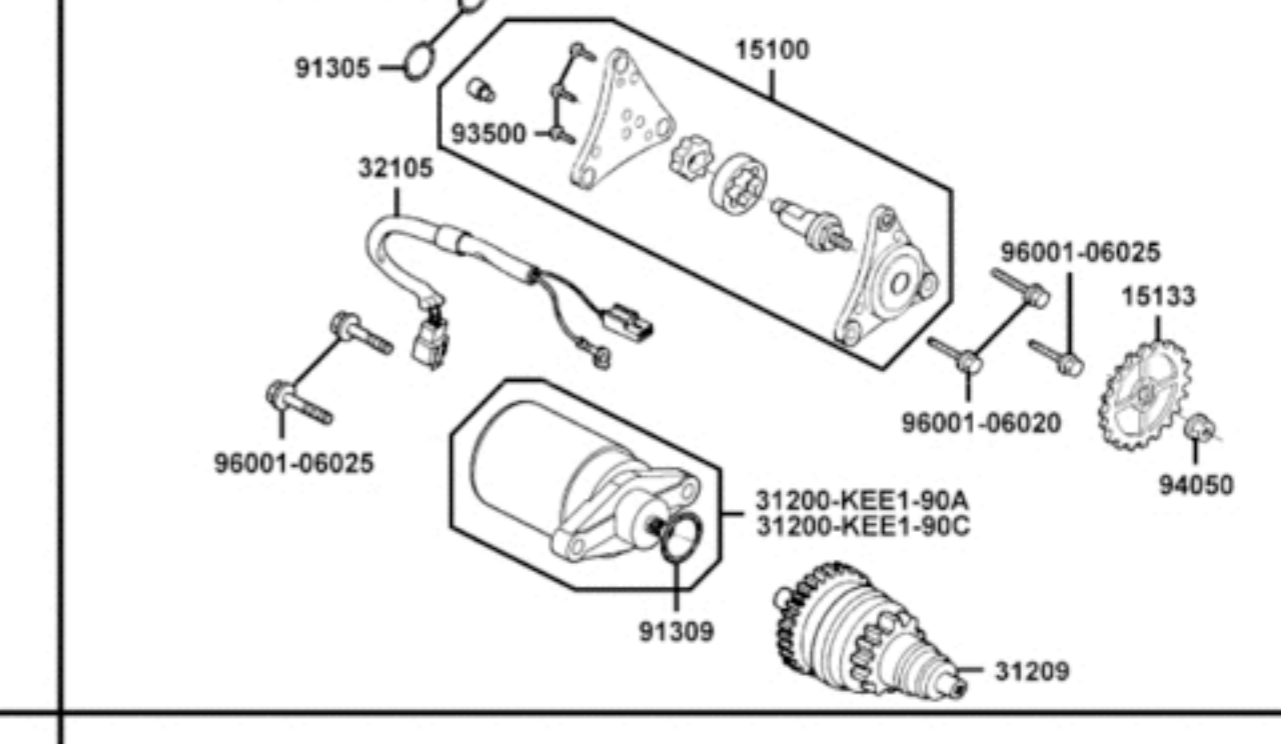

### E07 Luftleitbleche und Lichtmaschine

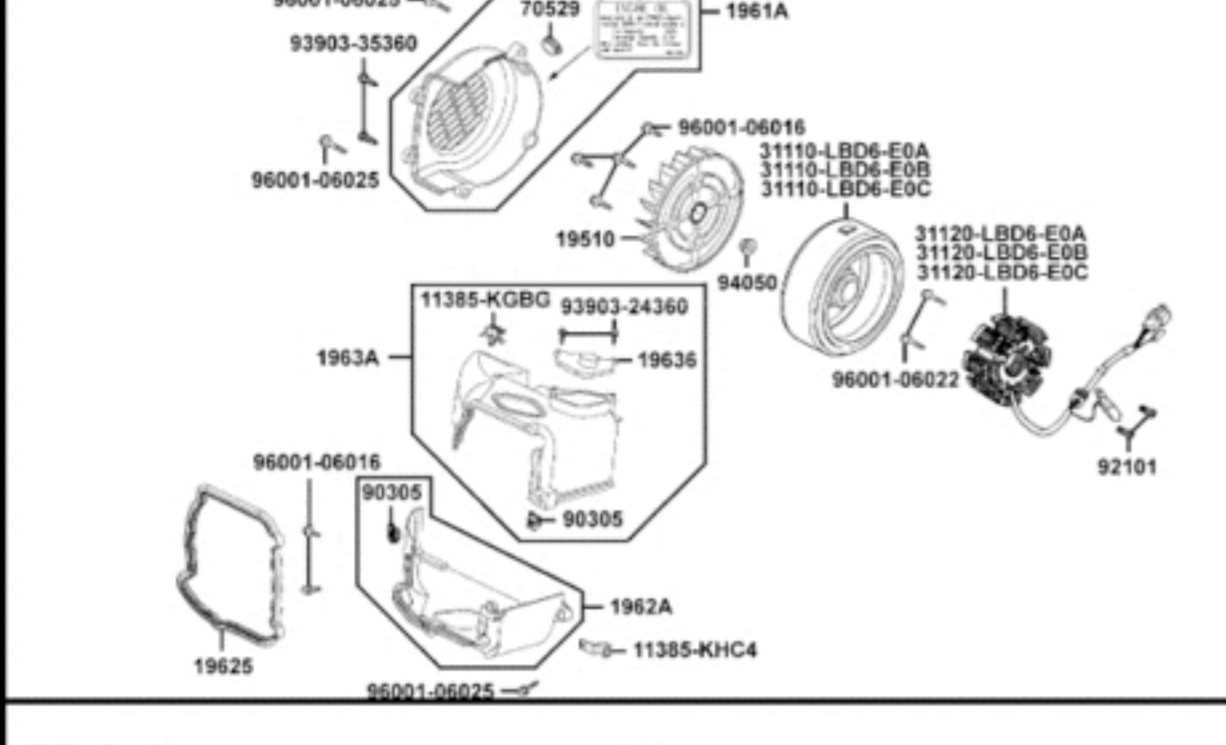

### E08 Getriebe

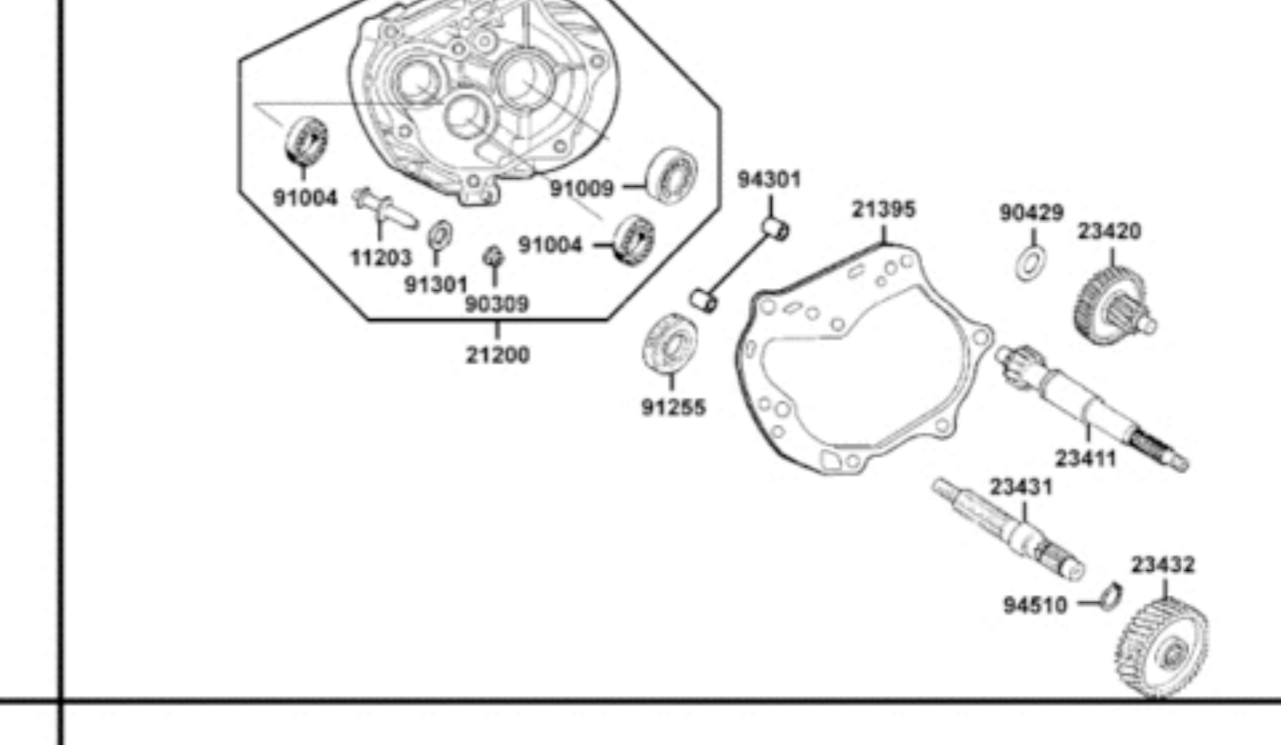

### E09 Vergaser

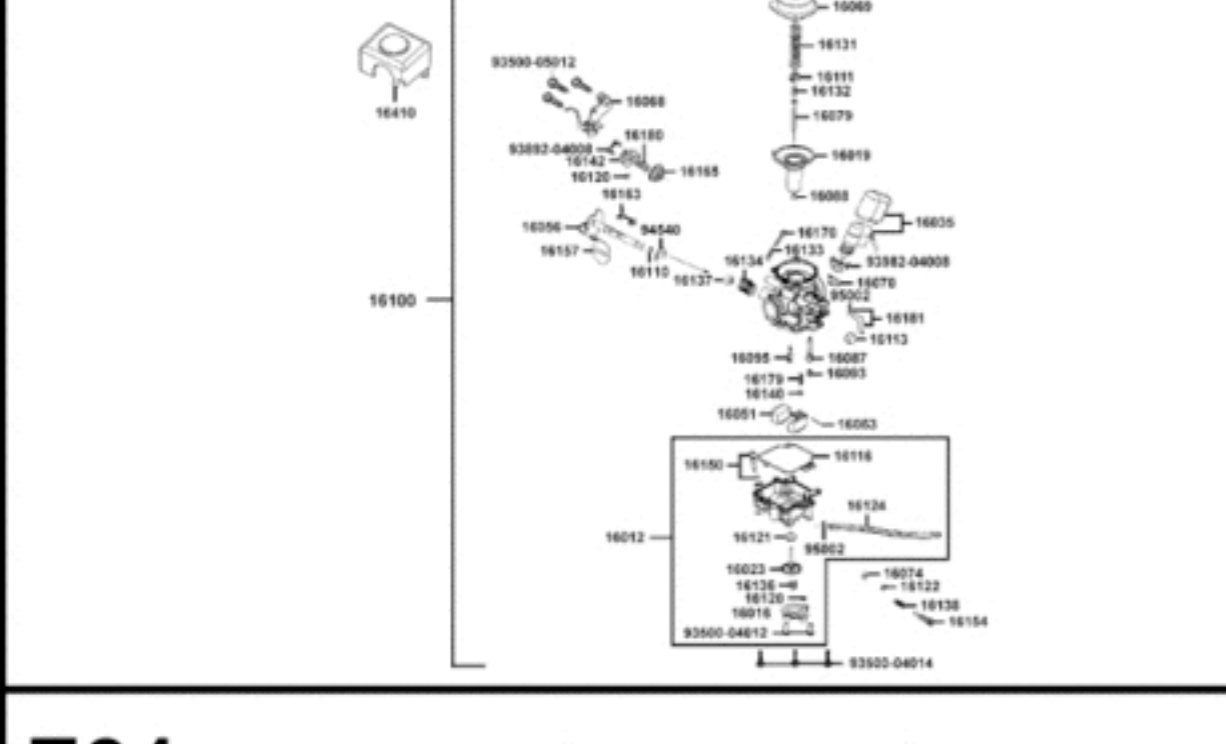

### F01 Scheinwerfer

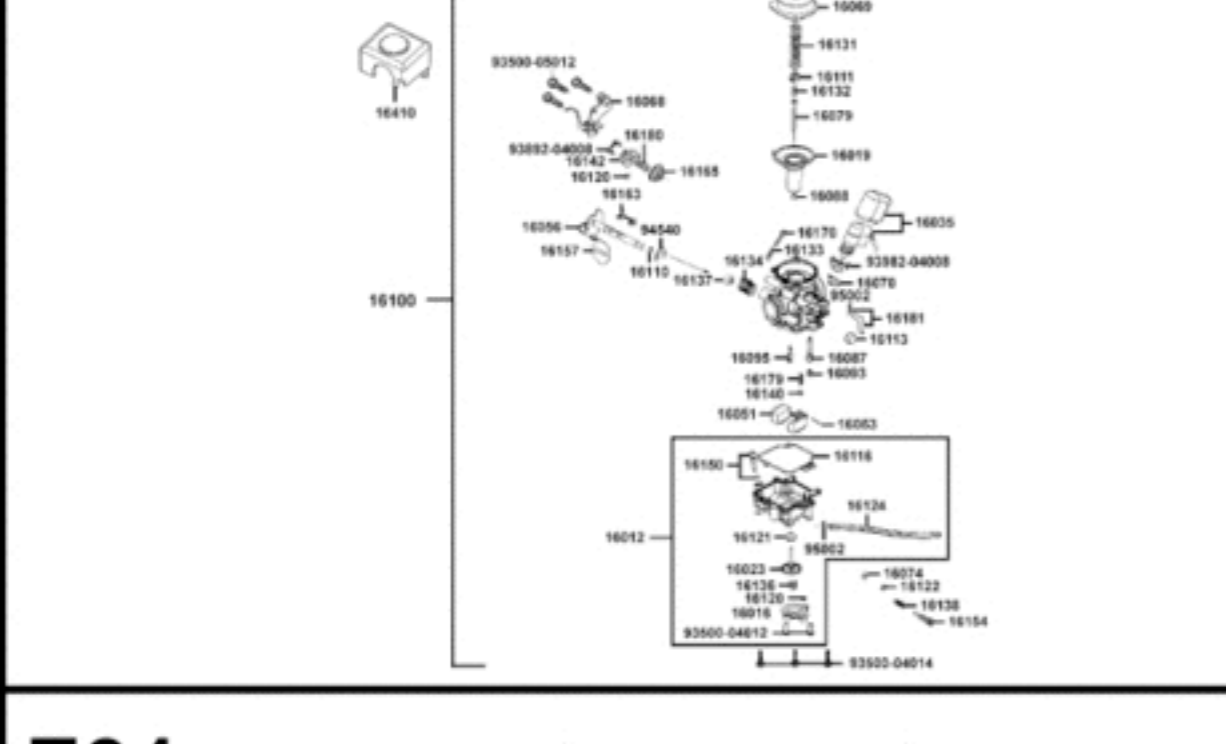

### F02 Tachometer

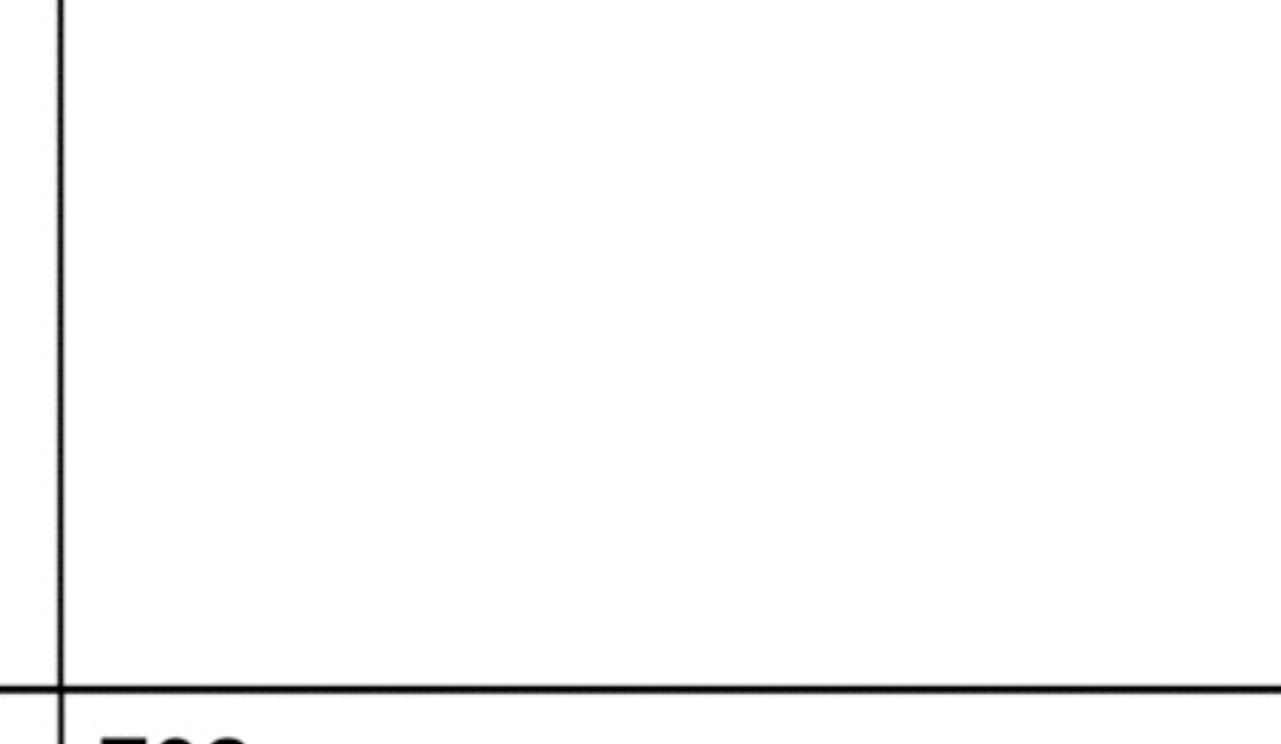

### F03 Griffe, Spiegel, Lenker und Lenkerverkleidungen

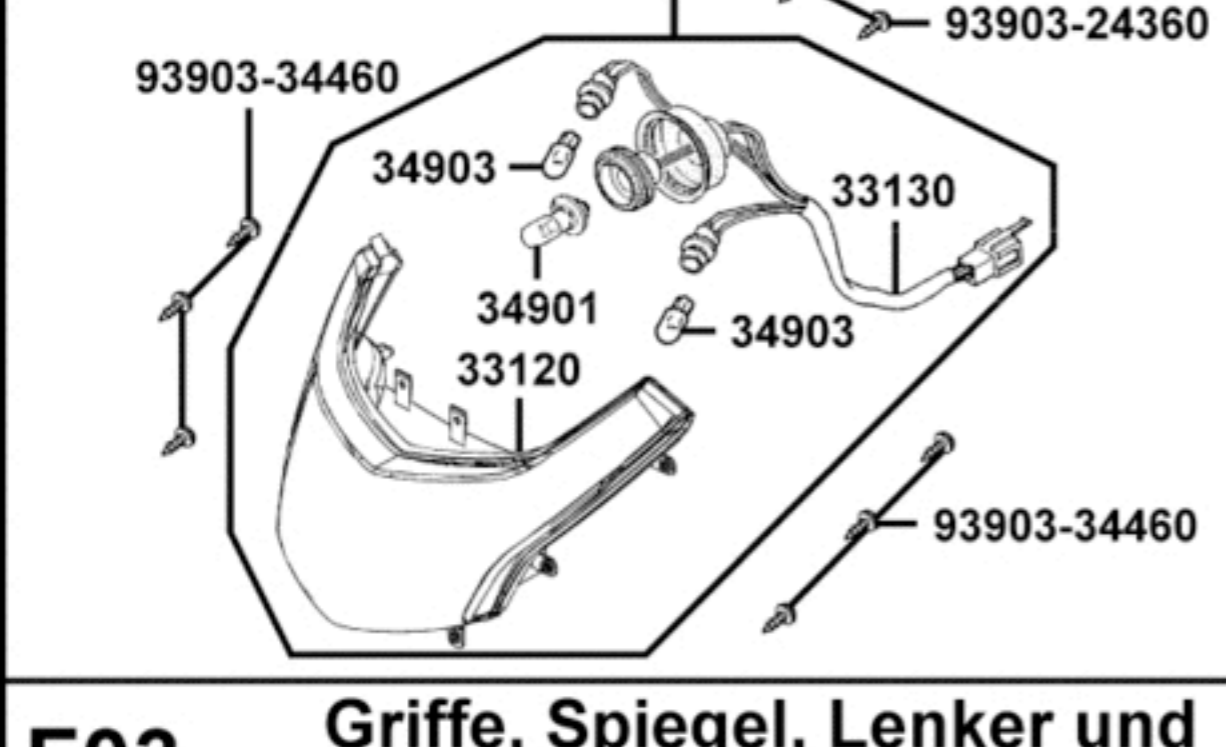

### F04 Hauptbremszylinder vorne und hinten

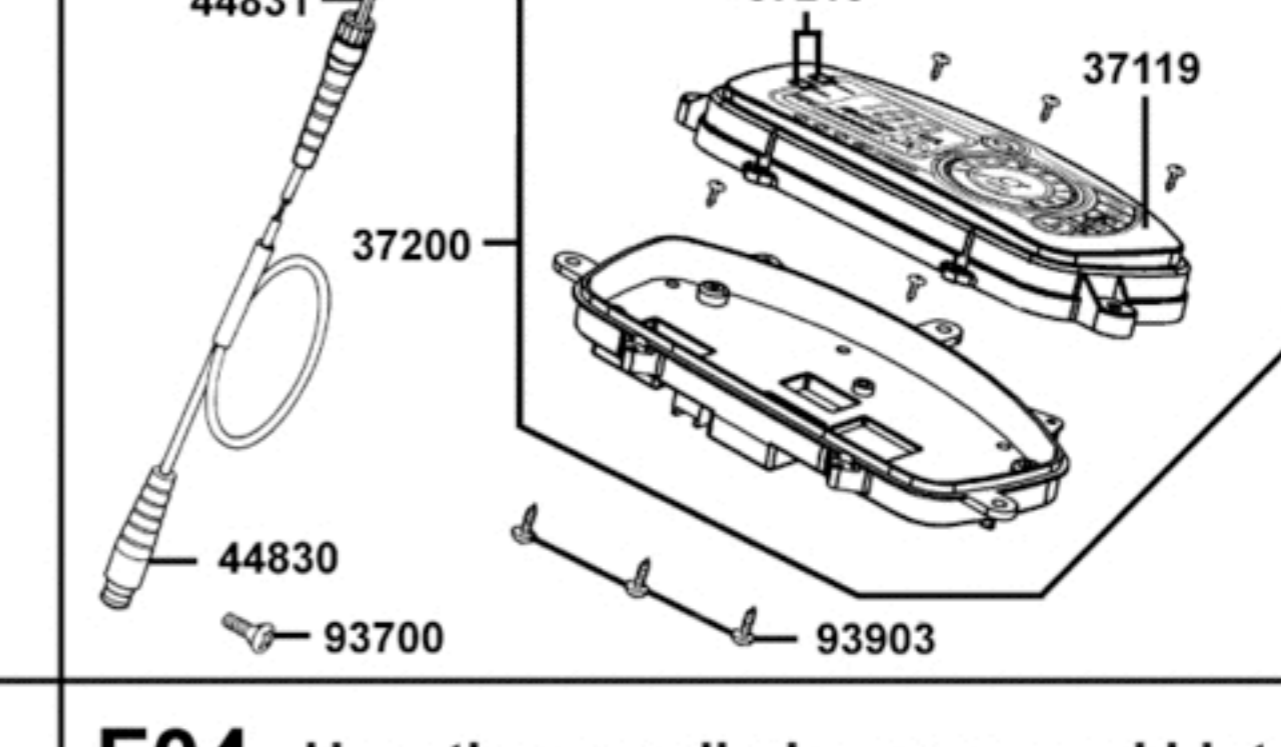

### F05 vordere Verkleidungen und Trittbrett

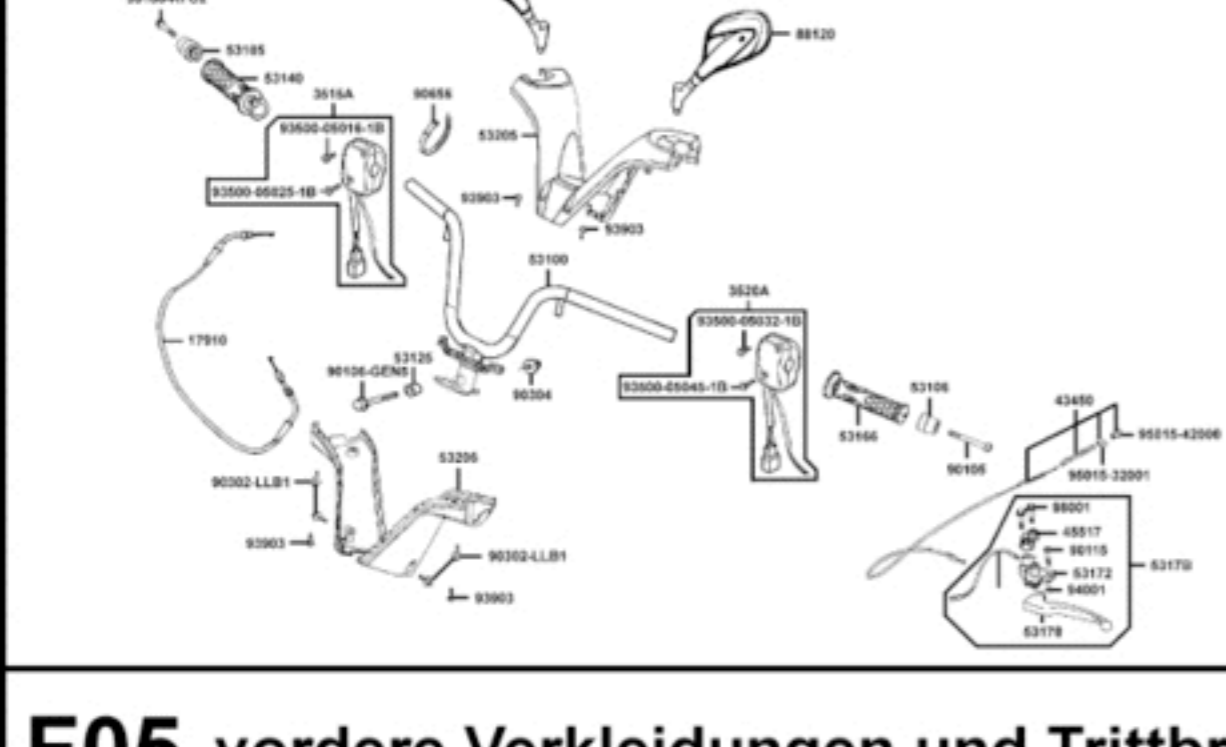

### F06 Gabeljoch, Lenkopflager und Gabel kpl.

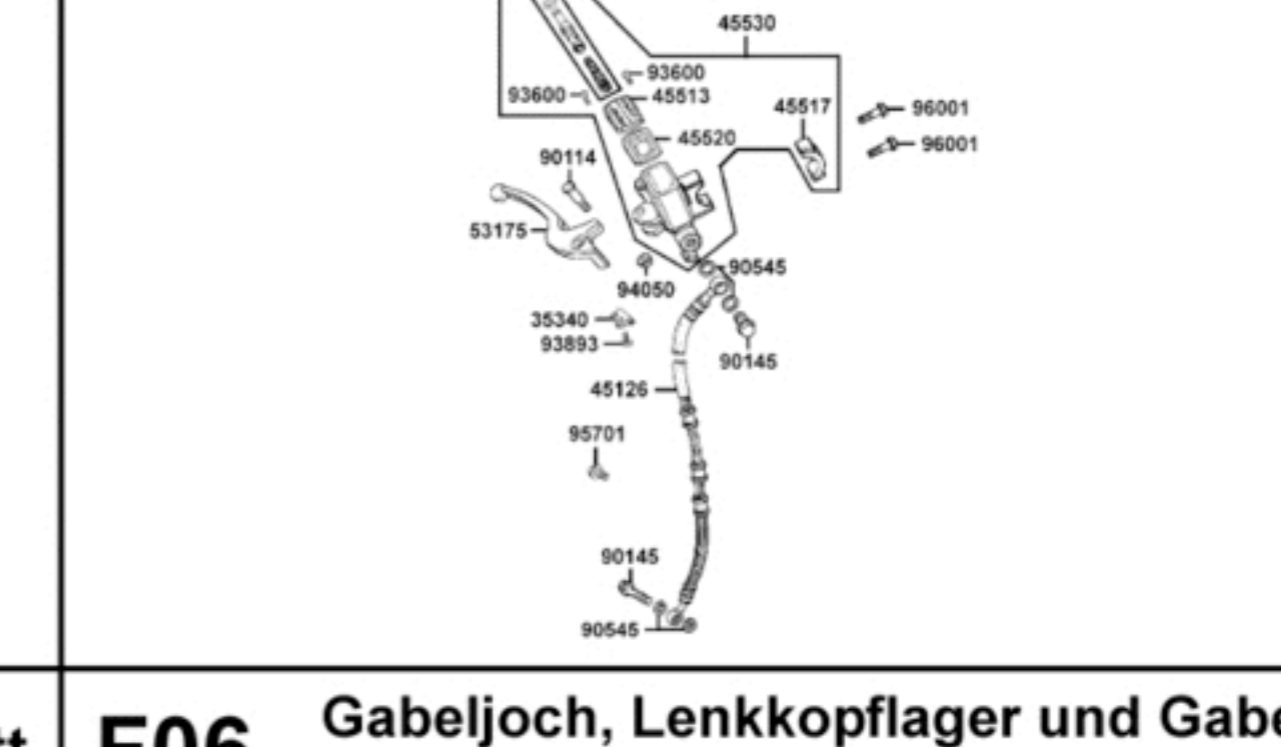

### F07 Vorderrad mit Bremsattel



### F08 Hinterrad mit Bremsattel

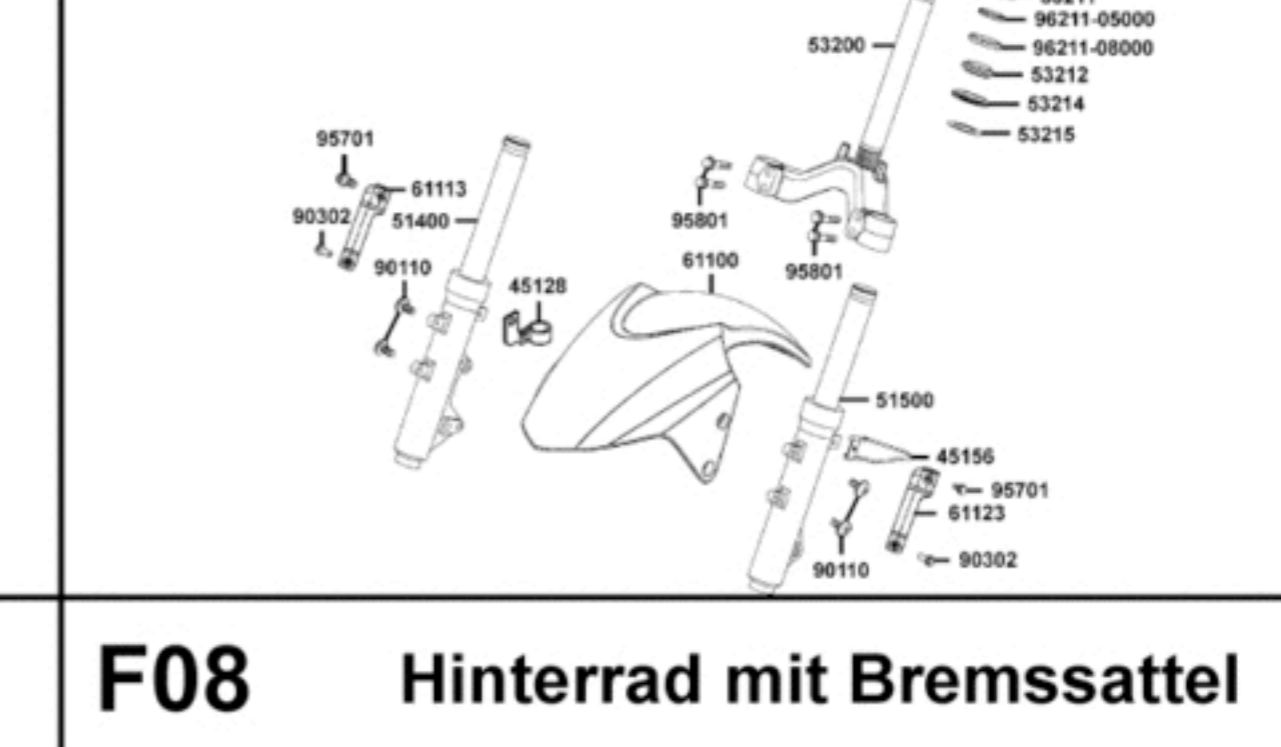

### F09 Sitzbank und Bordwerkzeug

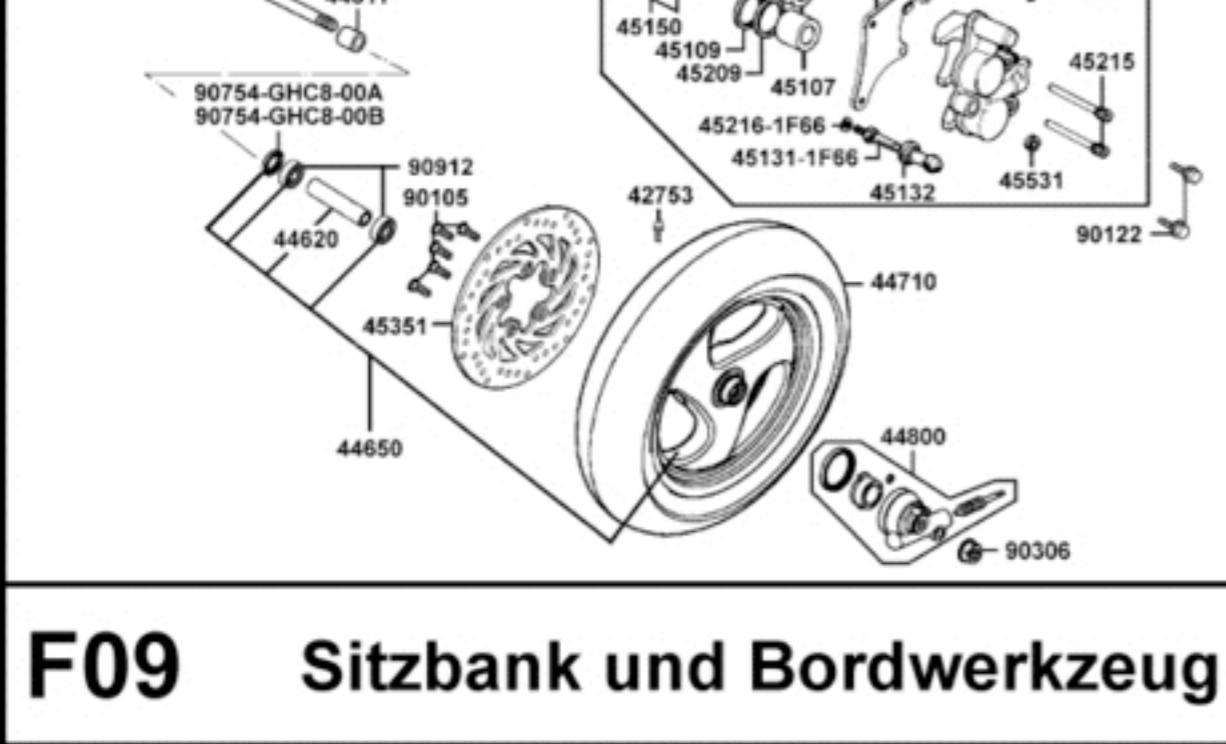

### F10 Tank und Benzinhahn

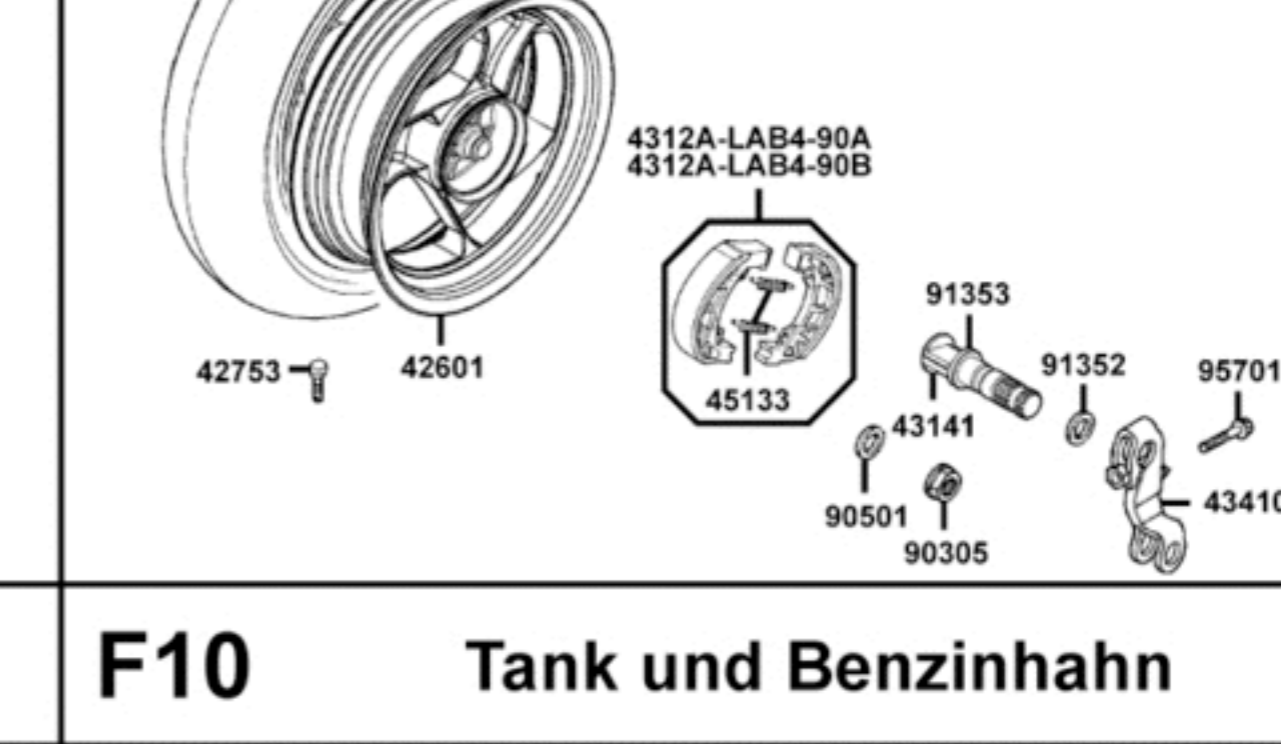

### F11 Batterie und Sicherung

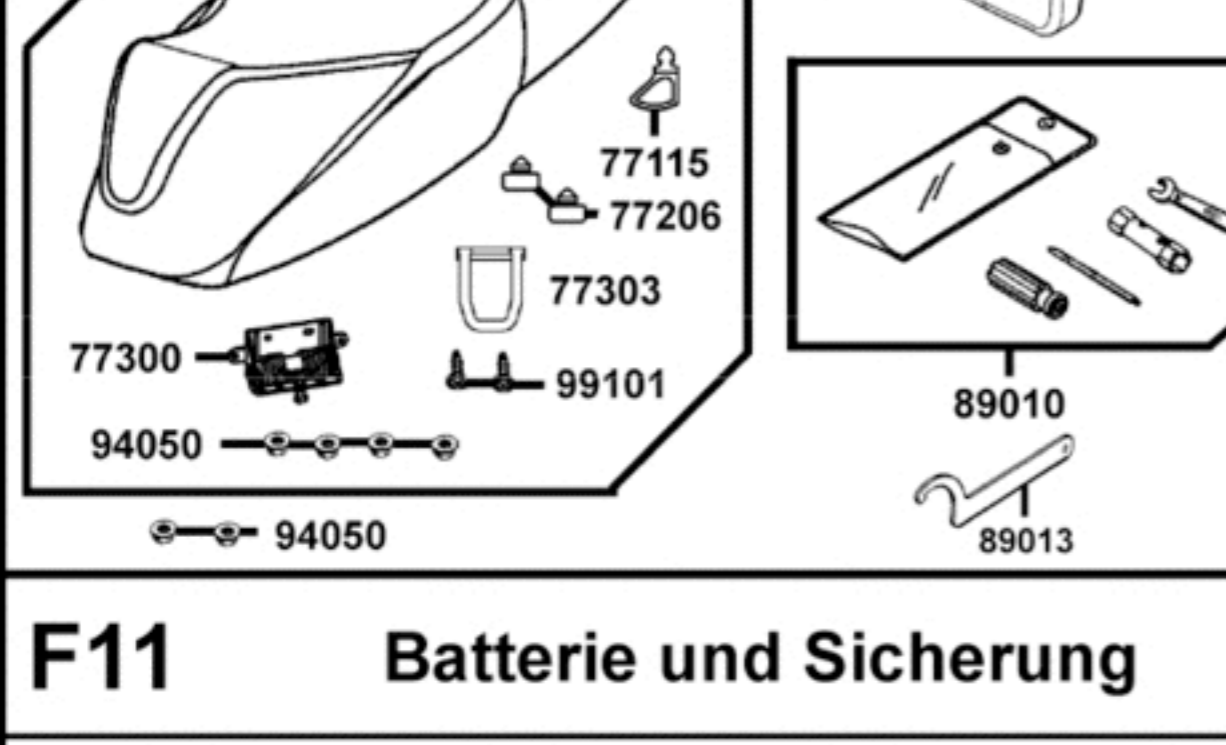

### F12 hintere Verkleidungen, Helmbox und Sitzschloss



### F13 Luftfilter und Gehäuse

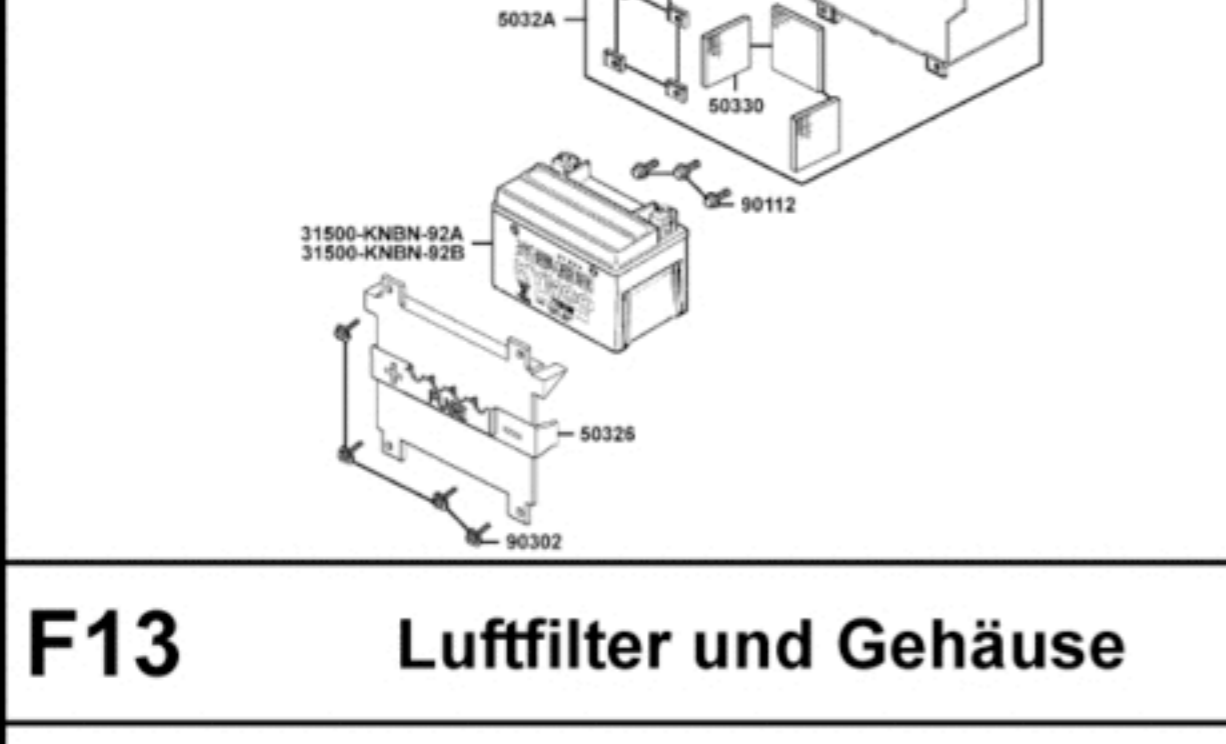

### F14 Auspuff mit Blende

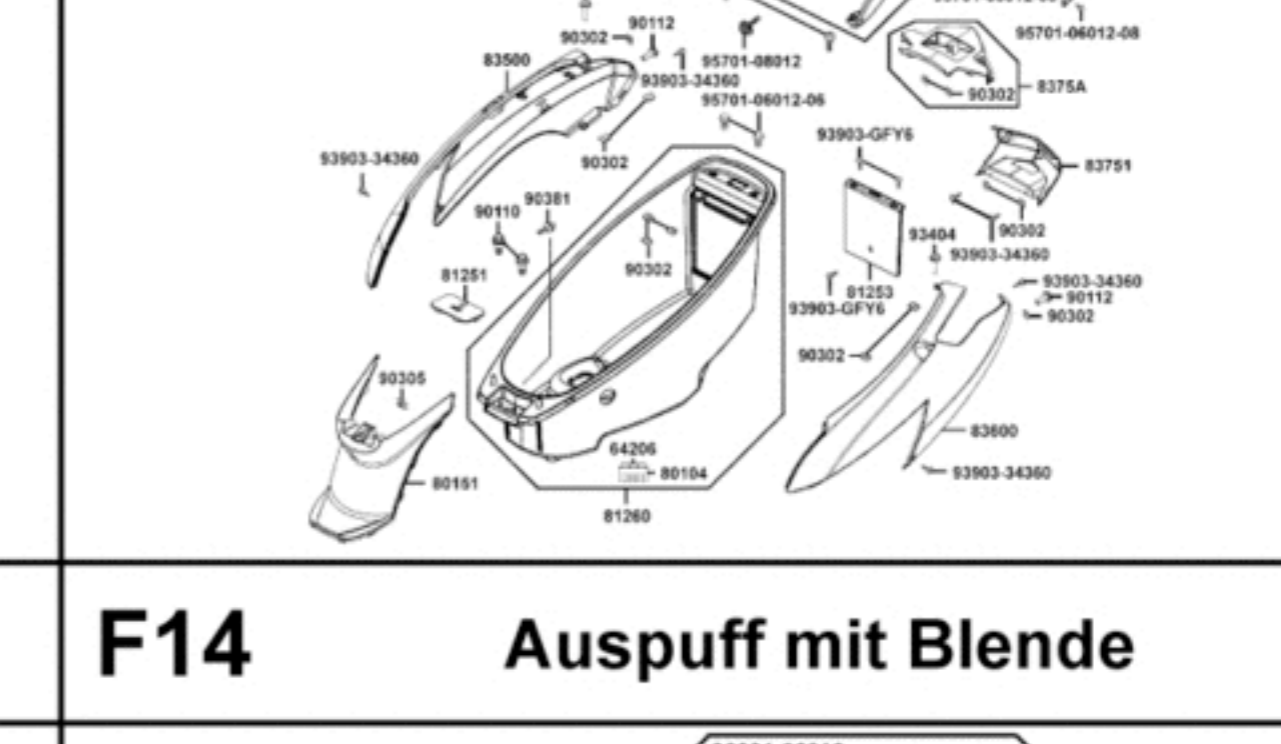

### F15 Ständer und Kickstarterhebel

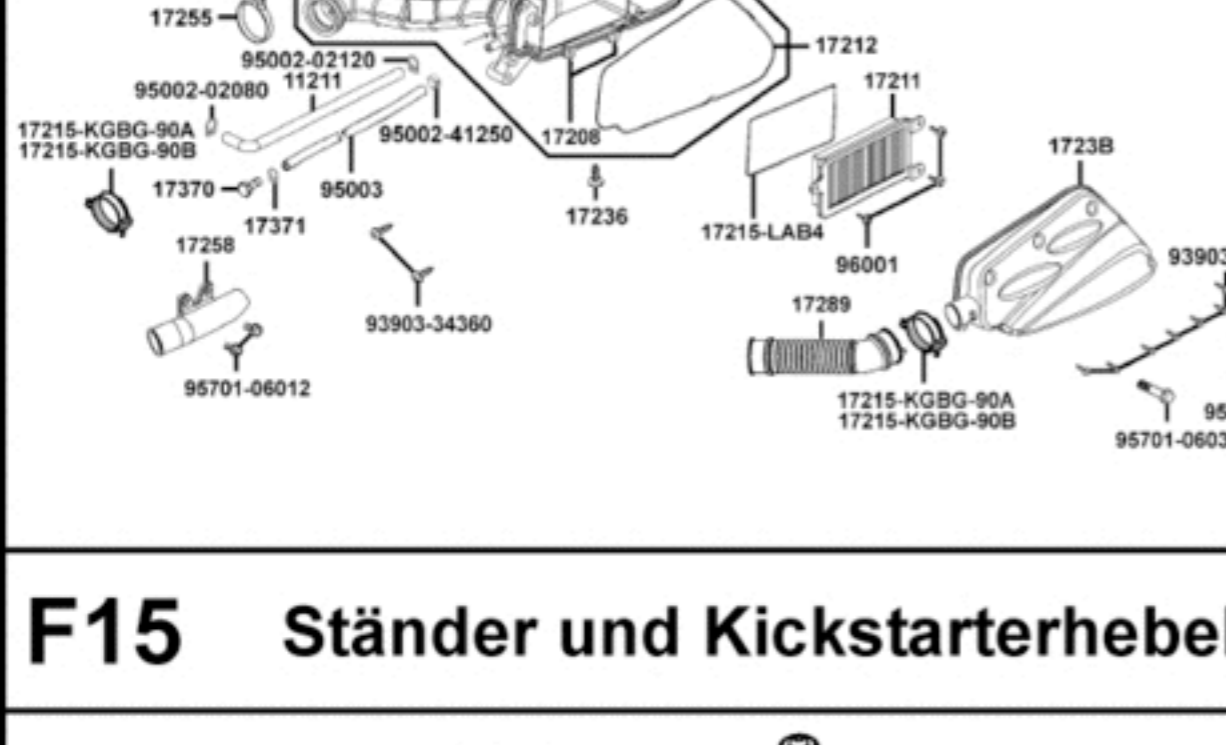

### F16 Stossdämpfer hinten

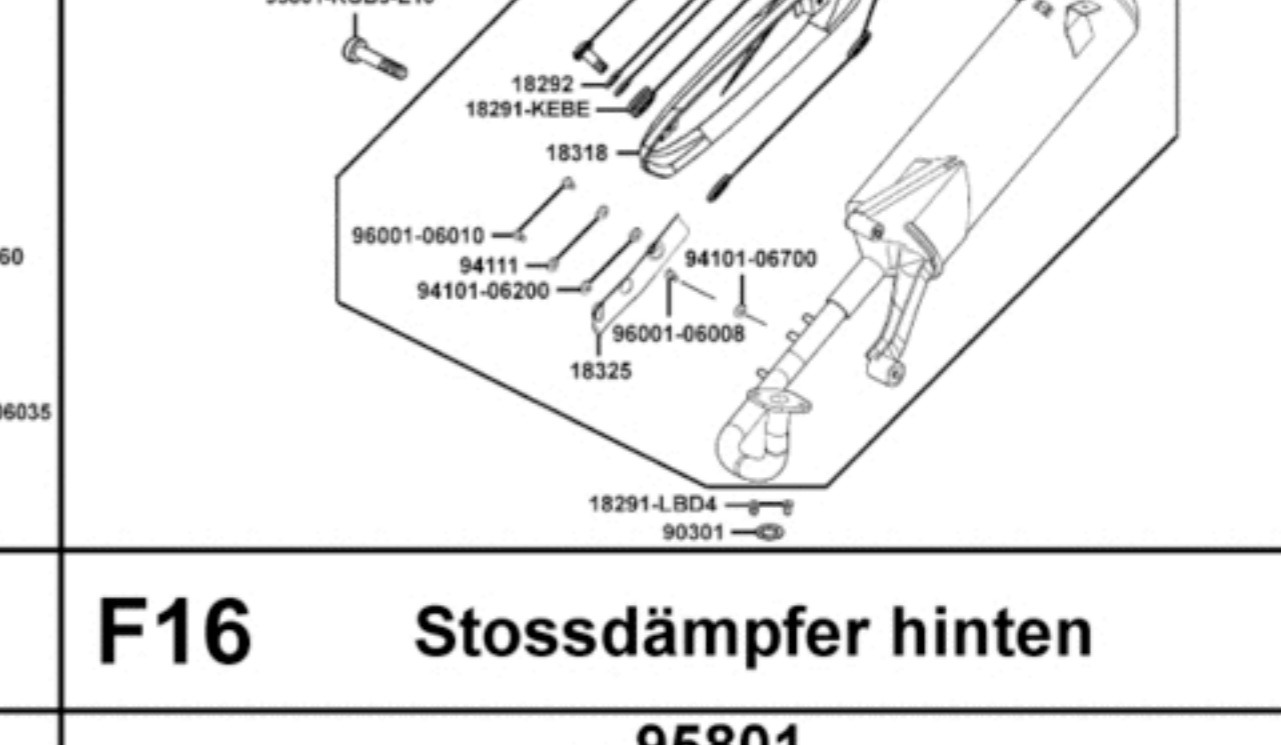

### F17 Blinker vorne

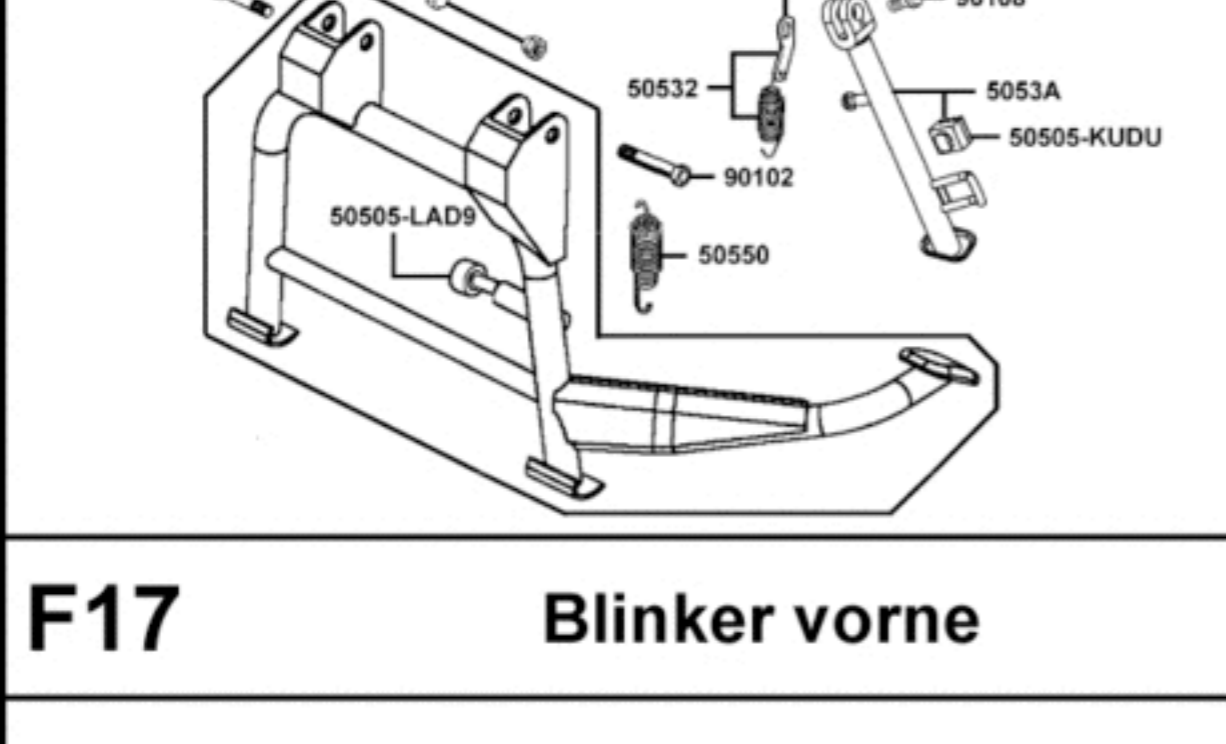

### F18 Rücklicht und hintere Radabdeckung



### F19 Elektrische Anlage und Schloss kpl.



### F20 Rahmen Chassis

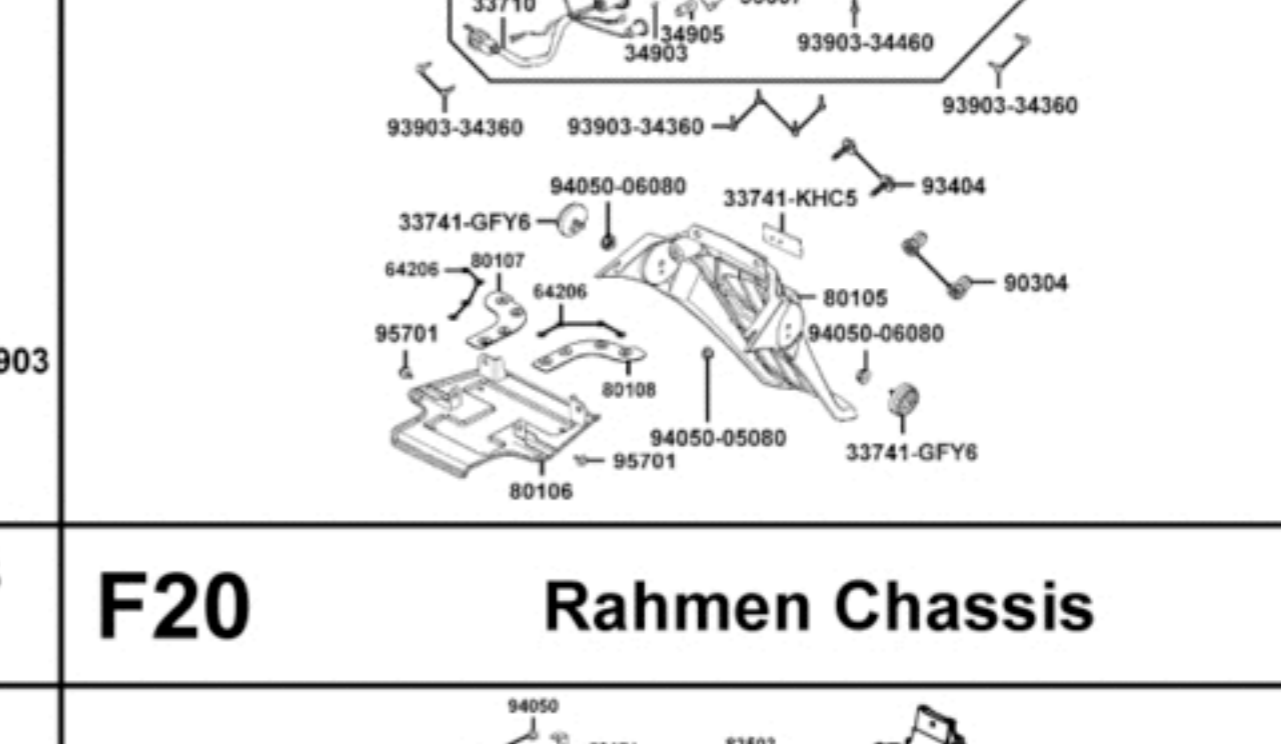

### F21 Gabel - Einzelteile

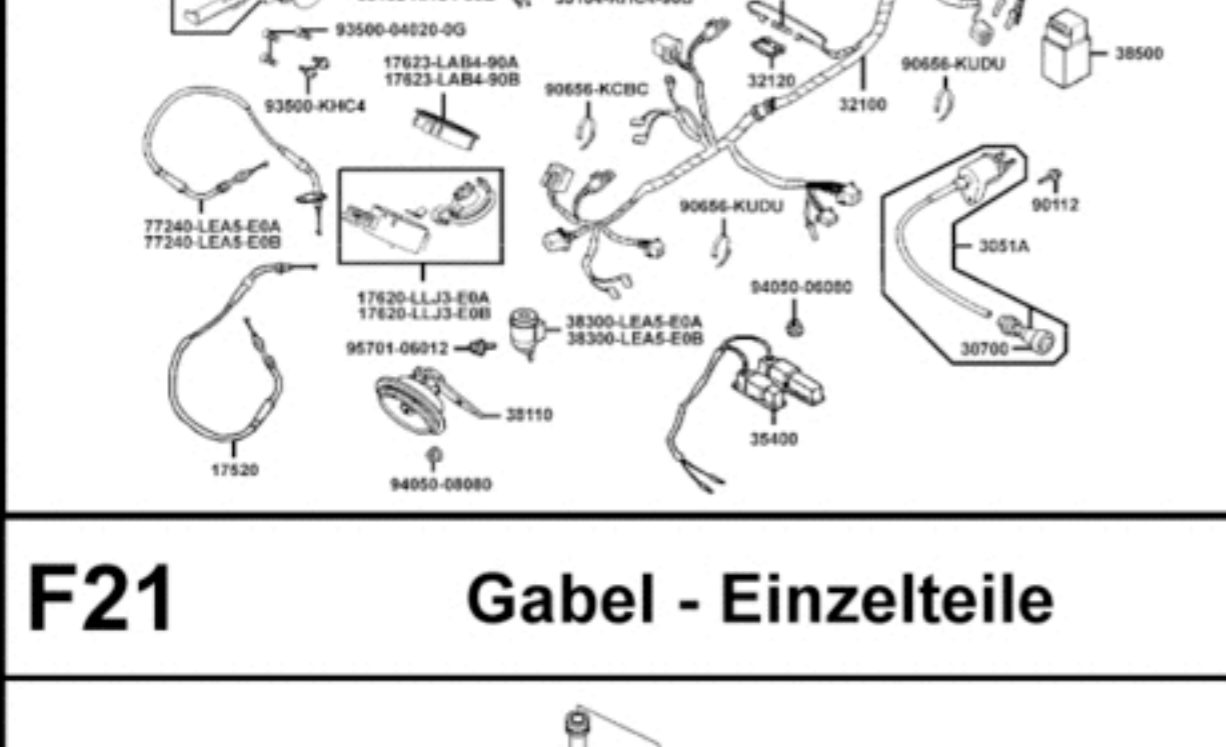

### F22 Sekundärluftsystem

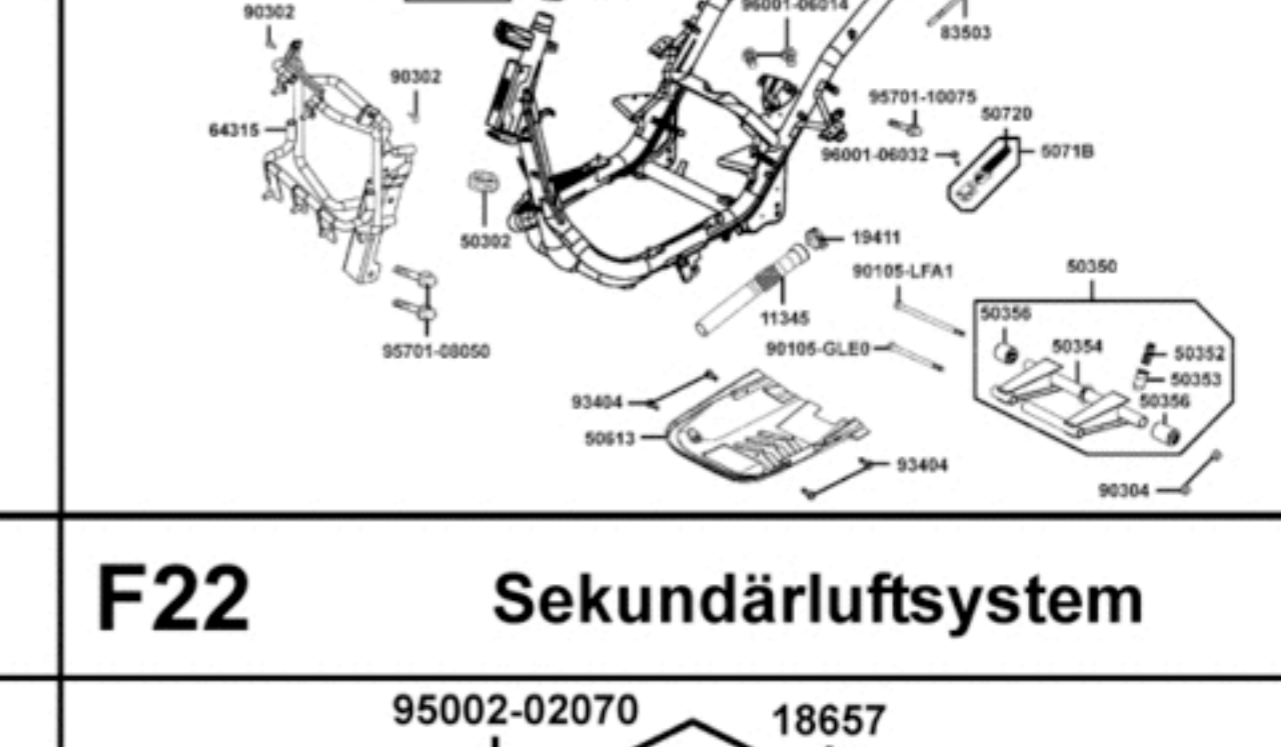

### F23 Hinweis - Schilder

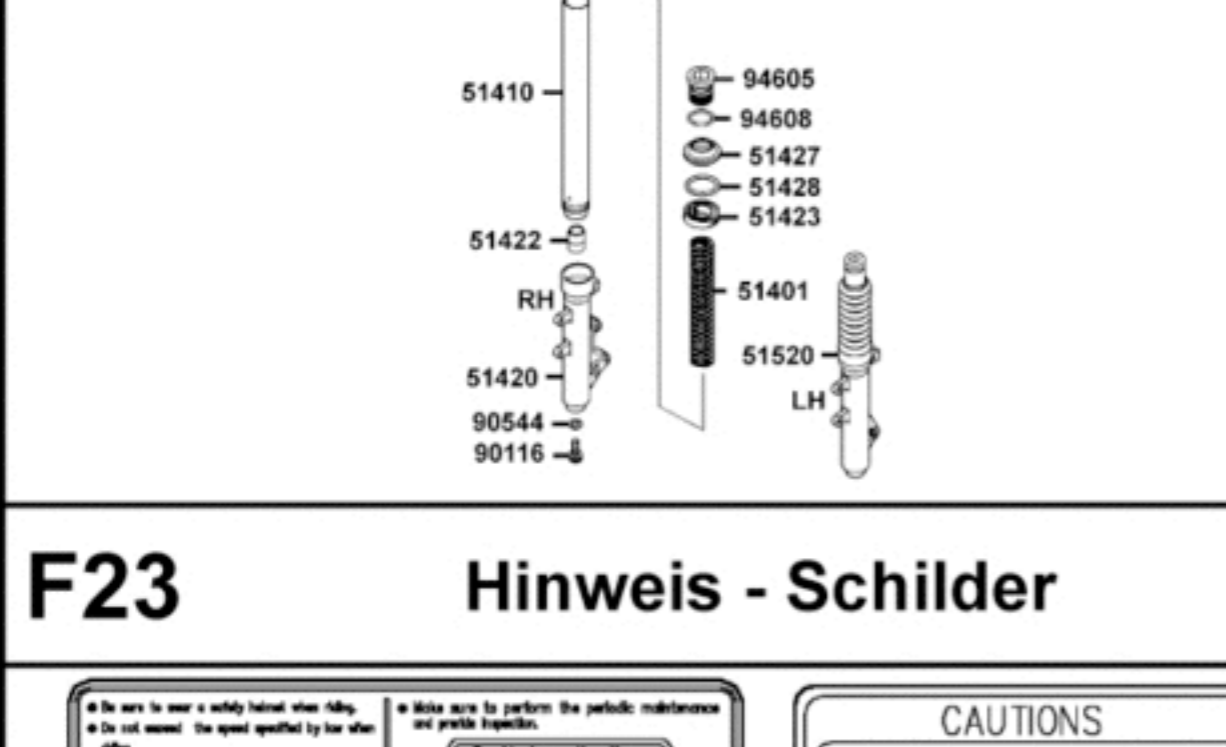

### F24 Aufkleber

